

## Explosion-proof junction box LTJB-eP-1/2.1-[24x12]-[LT-BM-X3(2/0/2/0)]



Explosion-proof plastic junction boxes

### Description

LTJB-eP junction boxes for connection or branching of round-sheathed armored or unarmored cables with copper or aluminum cores in AC and DC circuits of electrical installations in oil/gas and petrochemical industry.

### Installation

Flat surface mounting.

### Design

The housing is made of fiberglass-reinforced polyester. The enclosure consists of a housing and a cover. There is DIN rail with terminals inside the housing. Cable glands, couplings, end plugs can be installed on the sides of enclosure. Mounting straps, fasteners are made of corrosion-resistant steel.

### EX Mark

1 Ex e II T6 Gb / 0 Ex ia IIC T6 X Ga/ Ex tb IIIC Ta80°C Db – for junction box; 1 Ex e II Gb U / Ex tb IIIC Db U – for enclosure.

### Characteristics

Explosion-proof protection according "increased safety "e", "intrinsic safety "i", "dust ignition protection "t". Zones: gas explosion protection – 0, 1, 2; dust explosion protection – 20, 21, 22. Maximum rated voltage: 690 V. Maximum rated current: 125 A.

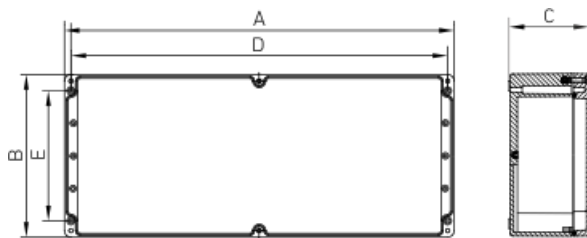

### Dimensional characteristics

A	Length	170 mm
B	Width	75 mm
C	Height	57 mm
D	Length (mounting)	98 mm
E	Width (mounting)	45 mm
	Weight	0.6 kg

### Technical features

1	Article no.	2327003000
2	Marking for gas	1 Ex e II T6 Gb
3	Dust marking	Ex tb IIIC T80 C Db
4	Mine gas coal dust marking	-
5	Electrical shock protection	I
6	Ambient temperature	-60 to +55 C
7	Climate application	Clim App1
8	Ingress protection (IP)	IP66
9	Mechanical shock protection	IK08/7 J
10	Electromagnetic compatibility (EMC)	Yes
11	Energy efficiency class	-
12	Housing color	Black
13	Warranty	18 months