

INOX LED 80 (GL/SS) 5000K /E/

LED luminaires for severe operation conditions

Description

Luminaires family for severe operation conditions. Are designed for usage at chemical, food and military plants. Wide modifications range to replace luminaires with compact and linear fluorescent lamps.

Installation

Mounting on bearing surface (wall/ceiling) with bracket

Design

The body is stamped from 0.8 mm stainless steel sheet. Body dimensions depend on luminaire power.

Optical part

Transparent protective tempered silicate glass 5 mm thickness. The glass is attached to body with metal clips.

Package

Assembled luminaire. Mounting bracket is included in delivery set. Mains connection cable - 0.5 m, 3x1 mm²

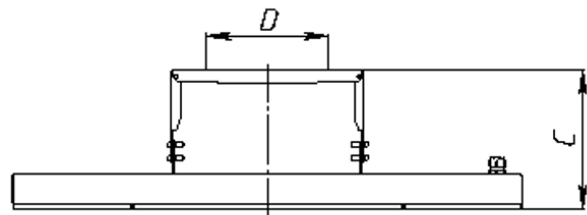
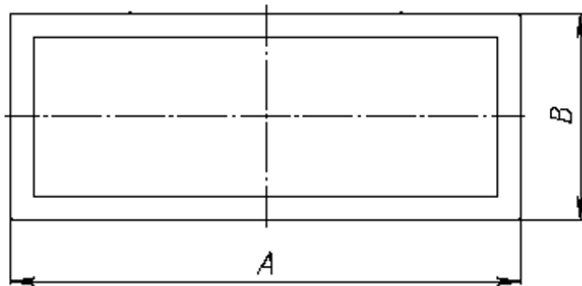
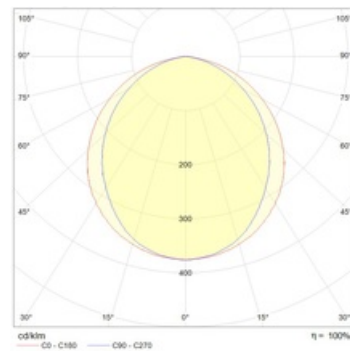

Dimensional characteristics

A	Length	757 mm
B	Width	307 mm
C	Height	205 mm
D	Length (mounting)	180 mm
	Weight	7.4 kg

Technical features

1	Article no.	1997025280
2	Light source	LED
3	Luminous flux	10000 lm
4	Power compatibility	82 W
5	Energy efficiency	122 lm/W
6	Color rendering index (CRI)	>80
7	Color temperature	5000 K
8	Power factor (cosFI)	> 0,90
9	Alternating/direct current (AC/DC)	Yes
10	Dimming	-
11	Rated voltage	230 V
12	Electrical shock protection	I
13	Electromagnetic compatibility (EMC)	Yes
14	Climate application	Clm App2
15	Ambient temperature	-40 to +40 C
16	Housing color	Grey
17	Fire protection class	I,II,IIa
18	Flickering	<5%
19	Ingress protection (IP)	IP65
20	Mechanical shock protection	IK08/6,5 J
21	Energy efficiency class	A+
22	Inrush current	45 A
23	Inrush current impulse time	0 μs
24	Emergency power supply unit	No
25	Beam angle	D120
26	Warranty	60 months
27	Autonomy in emergency mode	-
28	Light flux in emergency mode	-
29	Color of light	Белый